

NOTE

The measures used in this drawing were taken with GPS and satellite images and it has to be verified.

This drawing is not exhaustive, who implement, has to adapt technical solutions to the specifications of the place and existing constructions and infrastructures.

This project is aligned to the minimum standards used by UNHCR. Compliance with local and national regulations must be addressed with the competent authorities

PROJECT
UNGHENI COMMUNITY SERVICE CENTER

DRAWING TITLE
UNGHENI COMMUNITY SERVICE CENTER

DATE
AUGUST 22nd 2023

SCALE
DRAWING NUMBER

1

■ Floor plan

All the walls of the protection interview room need to be acoustic free, the two lateral walls are solid and the wall with the door is glass acoustic free and with a layer to avoid the view in the inside.

The rest of the walls (Rooms 1 to 3), breastfeeding room and work space, are the same type of wall divisions as in Cahul and Dondușeni. The wall in the middle of the protection interview room must also be removable.

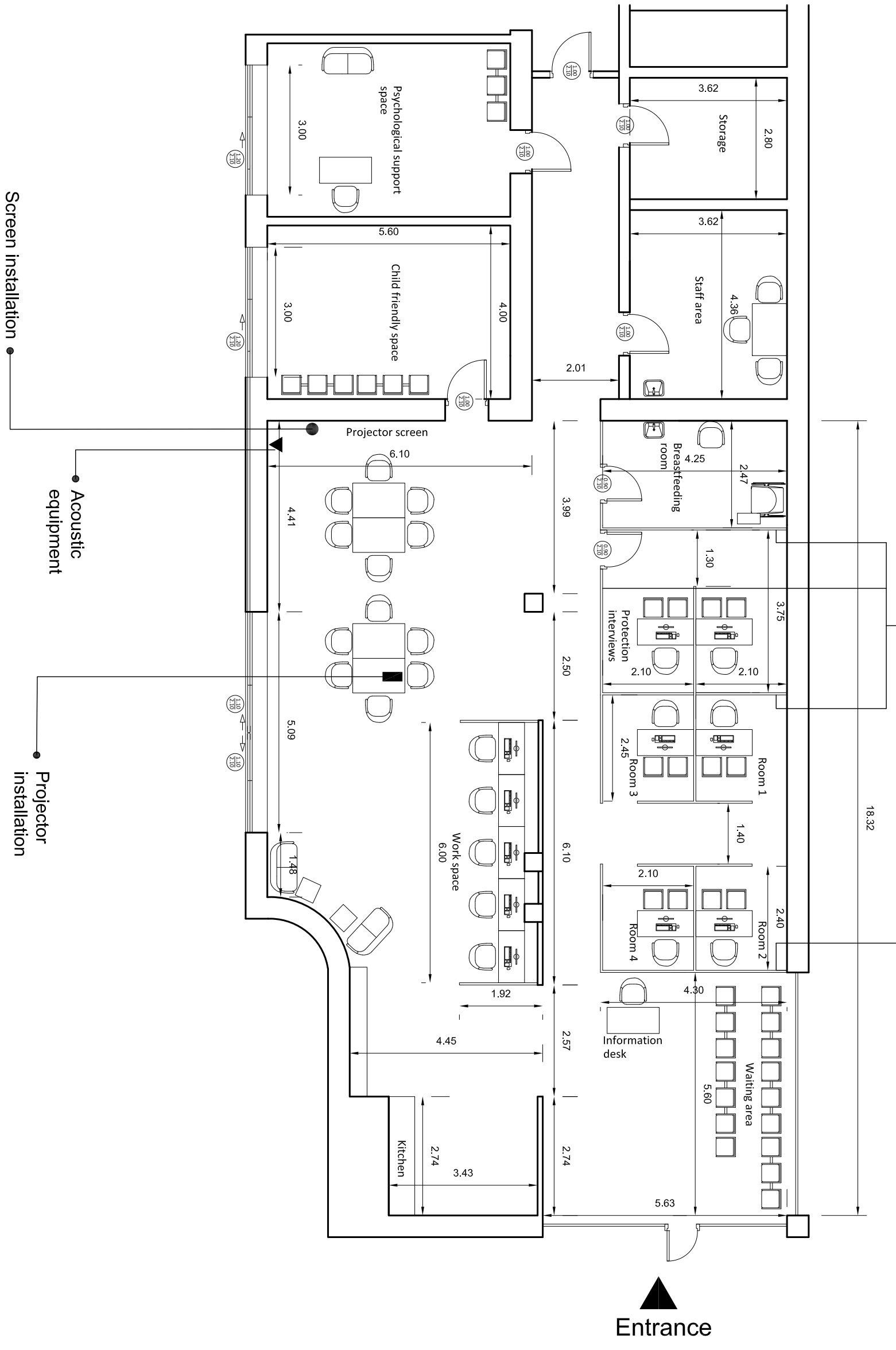

THE DIMENSIONS AND NAMES SHOWN AND THE RESPONSIBILITIES USED IN THIS DRAWING DO NOT IMPLY OFFICIAL ACCEPTANCE BY THE UNITED NATIONS